



Vehicle Feature Tips

Many of the Tips presented below are covered in greater detail in the Owner's Manual, Multimedia System Manuals, Features and Functions Guide, and Quick-Start Guide hangtag supplied with your new vehicle.

Voice Recognition¹ and Bluetooth^{®2}

Using Voice Recognition

Improve Bluetooth[®] Voice Recognition (VR) performance by making a few simple changes to your phone contacts:

- Use full names (first and last names) vs. short or single-syllable names ("John Smith" vs. "Dad," "Smith Residence" vs. "Home").
- Avoid using special characters, emojis, and hyphenated names (@, &, #, /, -, *, +, etc.).
- Avoid using acronyms ("Emergency" vs. "ICE" or "In Case of Emergency") or words with all capital letters.
- Spell words completely; system will not recognize abbreviations ("Doctor Smith" vs. "Dr. Smith").
- Always wait for the beep before speaking any commands.
- When using VR to place a call, speak in a natural, moderate tone, with clear pronunciation. The system may have trouble recognizing commands if you speak too softly or too loudly.
- Open windows, sunroof, weather (wind/rain), or an A/C fan operating at higher speeds can interfere with VR accuracy.
- Your VR system may have difficulty understanding some accents or uncommon names.
- Press the talk button and say "Help" to get a list of available commands.

Pairing or Connecting Your Phone with Bluetooth[®]

- Select "Device Connections" in the infotainment display or "Call" button on the steering wheel to begin the pairing process if no phone has previously been paired.
- During the pairing process, please make sure you accept all requests for phonebook download and future auto-connection on your phone.
- To pair a second phone or subsequent phones, reference the manuals and guides supplied with your Sorento as steps vary by infotainment system.

- If you experience any issues with auto-connection, try the following:
 - Reboot your phone (turn the phone off and then on).
 - Update the phone operating system to the most recently released version.
 - Delete the phone from the list of Bluetooth[®] devices on the infotainment system display¹ and delete Kia device from the list of Bluetooth[®] devices on your phone, and re-pair.
 - Ensure the phone has the Bluetooth[®] feature activated.
- If some contacts are not downloading to the infotainment system display, check to confirm that the contact has been entered correctly and that it has been stored under the categories (HOME, MOBILE, WORK, iPhone^{®3}) that are supported by the infotainment system display. Some contact categories (MAIN, PAGER, OTHER) may not be supported. If the number of contacts exceeds the maximum number allowed on the infotainment system display, contacts will be partially downloaded. Ensure that only the "phone contact list" is selected for contact download on your phone (not social media or email contact lists as these contacts may not download to the infotainment system display).
- Phone operating systems change frequently and some phones may have varying compatibility levels with the Bluetooth[®] system. For any questions regarding the features of your vehicle, please contact your preferred Kia dealer or contact Kia Consumer Assistance at 1-800-333-4542.

Other Bluetooth[®] Tips

- Bluetooth[®] reception is affected by carrier coverage and is dependent on the phone.
- If streaming audio through Bluetooth[®] from a device, ensure the listening volume on the device is turned up.

Smartphone Connectivity¹



Apple CarPlay^{®3}

Your vehicle offers you effortless command of your compatible iPhone[®] when you connect through Apple CarPlay[®] on your infotainment system display. This will enable you to make calls, send hands-free texts, access many of your favorite apps and music, and get navigation help with Siri[®] voice control.

To connect Apple CarPlay, visit <https://youtu.be/98TNWMOQfdU>



Android Auto^{™4}

Your vehicle allows you to connect to your compatible Android[™] phone via Android Auto[™] on your infotainment system display. Through this feature, you can access music, your phone's dialer, navigation help, and more with an intuitive interface and voice commands. You can even access your phone through your steering wheel controls.

To connect Android Auto, visit <https://youtu.be/sTR4KotSOZU>

For select models equipped with wireless Apple CarPlay and Android Auto, visit <https://youtu.be/oUXXuAZAOEI>

Kia Access App^{*5}



- Your cellphone and your vehicle have to be connected to a cellular network with a good wireless signal strength in order to use Kia Connect (formerly UVO link). If these conditions are not met, remote commands may not execute or may take longer to execute.
- To use Remote Start or Remote Start with Climate Control feature, all doors, hood and trunk/liftgate must be closed and locked. Remote Start or Remote Start with Climate Control feature will operate for about 10 minutes.⁶
- The quickest way to obtain an accurate vehicle status is by pressing the refresh icon on your app or customer web portal.
- Activate Remote Start or Remote Start with Climate Control feature a few minutes before you plan to get into the vehicle. This will allow vehicle interior to reach a desired temperature.
- In order to preserve vehicle battery, Kia Connect will not work seven days after the ignition was last turned on. You will need to re-start your vehicle with a key fob in order to use Kia Connect again.

Feature Videos

To view a video on your mobile device, snap this QR Code or visit the listed website: <https://www.youtube.com/KiaFeatureVideos>



Power-Folding Outside Mirrors*

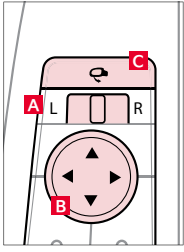

- A** Toggle the L or R buttons to select the mirror to adjust.
- B** Press button arrows left/right or up/down to adjust mirror position.
- C** Toggle button left/right to unfold/fold the outside rearview mirrors.
- A** Toggle button to center to automatically fold/unfold mirrors when:
 - The Smart Key* Lock/Unlock buttons are pressed.
 - The door outside handle button* is pressed.

Quick Tip:

The mirrors will automatically unfold when the Smart Key* is within close proximity to the vehicle.

Reminders:

- When the mirror button **A** is in the center, press the Lock button on the Smart Key to automatically fold the mirrors.
- To lock the mirrors from being moved by the arrow toggles, make sure that the toggle switch is in the neutral (center) position.

Accessory Mode with Smart Key*

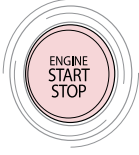

With standard key vehicles, you can turn the key to the Accessory mode and utilize the electronic accessories without starting the vehicle. This is still possible with Smart Key-equipped vehicles. To do this, enter the vehicle with the Smart Key and push the ENGINE START/STOP button one time without depressing the brake pedal. This will put the vehicle in Accessory mode and ACC will illuminate in AMBER.

- If the ENGINE START/STOP button is in the ACC position for more than 1 hour, the button is turned off automatically to help prevent battery discharge. If the Smart Key battery is weak or not working properly, hold the Smart Key fob up to the Engine Start/Stop button (with the Lock button side closest), and press to start the engine.

Rear Liftgate Operation⁷

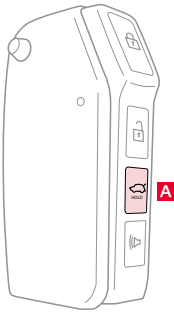

Manual Liftgate:

Remote/Smart Key* liftgate button ONLY UNLOCKS the liftgate.

With a Smart Key, simply approach the liftgate to unlock, then raise the hatch manually. With a mechanical key, press and hold the Liftgate button **A** to unlock, then manually open.

Power Liftgate*:

Remote/Smart Key liftgate button opens and closes the liftgate.

For your convenience, the liftgate opening height is adjustable. The liftgate speed can also be adjusted in the LCD Instrument Cluster.

To program the opening height, perform the following:

- Open liftgate and manually position it to your preferred opening height.
- Depress and hold the close button on the liftgate for 3 seconds or more.
- The system will beep 2 times when the programming is complete.

If you unlocked your vehicle or opened the rear tailgate by pressing the unlock button on your Remote/Smart Key, be sure to re-lock your vehicle using the lock button on the Remote/Smart Key before walking away. Please note – All doors must be locked for the liftgate to lock automatically after it is opened then closed.

Driver Attention Warning (DAW)⁸

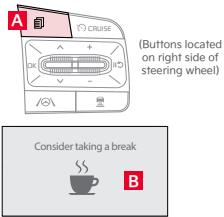

DAW is designed to alert the driver if it detects inattentive driving practices and, in certain situations, can give a warning signal to take a break from driving.

To enable/disable DAW: With the ignition on, press the Mode button **A** on the steering wheel and go to User Settings in the Instrument Cluster. Then go to Driver Assistance and select Driver Attention Warning. Set DAW to Normal Sensitivity, High Sensitivity or Off.

If DAW is activated, the DAW information will appear on the Instrument Cluster display **B** when you select the Assist mode.

Wireless Smartphone Charging System*⁹

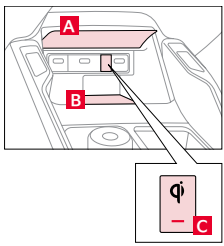

Charge a compatible smartphone wirelessly by placing it on the tray **B** at the front of the console, near the Multimedia USB ports and the charging indicator, while the ignition is on.

1. Enable Wireless Charging in the User Settings.
2. Slide open cover **A**. Place the smartphone on the center of the charging pad **B**.
3. Indicator light **C** may change to AMBER once wireless charging begins.
4. Once charging is complete, the AMBER light may change to GREEN.

Notes: Requires Qi enabled device or Qi enabled case.

For wireless charging to occur, all doors (excluding the rear hatch) must be closed and the Smart Key Fob must be detected inside the vehicle.

Windshield Defogging

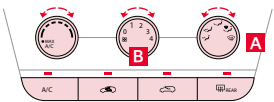

Windshield fogging is caused by moisture in the air condensing on the cold glass. The following practices can help reduce window fogging:

- Keeping the inside of the glass as clean as possible.
- Utilizing the Defrost Mode **A** activates the A/C and opens Fresh Air Vent.
- Adjusting the Temperature Control **B** to hot.

Seat Warmers / Ventilated Seats*¹⁰

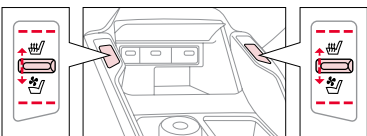

- Press button once for high setting. Up for heat, down for ventilation (3 LEDs lit).
- Press button twice for medium setting. Up for heat, down for ventilation (2 LEDs lit).
- Press button 3 times for low setting. Up for heat, down for ventilation (1 LED lit). And once more to turn OFF.

With the seat warmer switch in the ON position, the heating system in the seat turns OFF or ON automatically depending on the seat temperature.

Intelligent Speed Limit Assist / Manual Speed Limit Assist (ISLA/MSLA)¹¹

ISLA is designed to use the information from the posted speed limit and the navigation system to inform the driver of the speed limit. MSLA monitors the vehicle speed and warns the driver when the vehicle surpasses the preset speed limit. A warning indicator will blink on the Instrument Cluster and a warning alert will sound until the vehicle speed returns to or is below the preset speed limit.

For more information, please see the Features & Functions Guide for operation.

Blind-Spot Collision-Avoidance Assist (BCA)*12

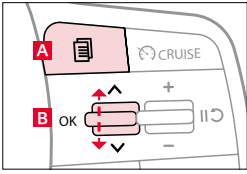

The BCA system uses radar sensors in the rear bumper to help monitor and warn the driver in certain situations if it detects an approaching vehicle in the driver's blind spot area.

To turn BCA on, go to the User Settings menu in the Instrument Cluster or touch screen;¹ press the Mode button **A** on the steering wheel when the vehicle is at a standstill, gear shift into Park, and with the ignition switch or the Engine Start/Stop button* in the ON position, select User Settings. Press the Move (OK) button **B** up/down and select Driver Assistance, Blind-Spot Safety, and then press the OK button **B**.

To set the initial warning activation time, go to User Settings > Driver Assistance > Warning Time, and press the OK button **B**. Select the Early/Normal or the Late option.

1st-stage alert: When another vehicle is detected within the BCA system warning boundary, an AMBER indicator will illuminate on the outside rearview mirrors.

2nd-stage alert: When 1st-stage alert is on and the driver activates a turn signal, a flashing AMBER indicator will illuminate on the outside rearview mirrors and the system will sound an alert.

Note: Alert noise can be adjusted in the Instrument Cluster or 10.25" touch screen.¹

Lane Keeping Assist (LKA)¹² / Lane Departure Warning (LDW)¹²

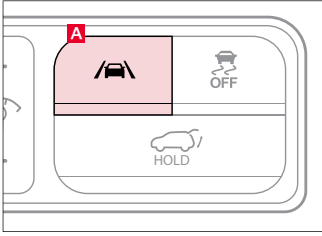

(Located on Driver's Panel to the left of the steering wheel)

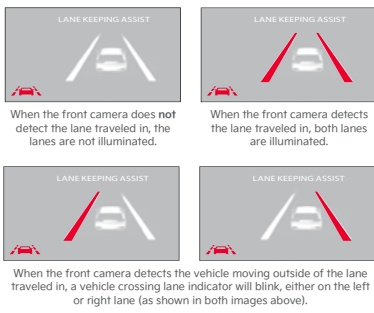

LKA is designed to detect the lane markers on the road with a front view camera on the windshield, and may assist the driver's steering to potentially help keep the vehicle in the lane. When turned on, the Instrument Cluster indicator  will initially illuminate WHITE. It will remain WHITE when the vehicle is traveling slower than 40 mph or when the system does not detect the lane markers. When the system detects the lane markers and can assist the steering, the LKA icon will illuminate GREEN.

If the LKA detects that you are moving outside of your lane, the system may give an audible warning and display an LDW alert on the Instrument Cluster. If the vehicle continues to move outside of the lane, LKA may provide steering inputs, trying to prevent the vehicle from moving outside its lane.

LKA is the operating mode by default when the Lane Safety/LKA button **A** is depressed to ON.

There are 3 available modes:

- **Active LKA** – Provides more frequent steering inputs than standard LKA.
- **Lane Keeping Assist** – Guides driver to keep vehicle within lanes and provides steering inputs when vehicle is about to deviate from the lane.
- **Lane Departure Warning** – Alerts driver when the system detects the vehicle leaving the lane. In this mode the system will not provide steering inputs.

All systems will operate under the following conditions:

- The vehicle speed exceeds approximately 40 mph.
- LKA recognizes both sides of the lane markers the vehicle is traveling in.
- The vehicle is between the lane markers.

Lane Following Assist (LFA)¹²

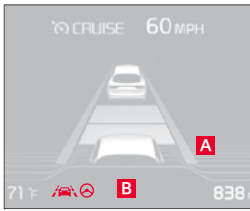

LFA is designed to help ensure that the vehicle stays centered in its lane **A** by monitoring the detected lane markings ahead and adjusting the steering. Once ON, the Instrument Cluster indicator will initially illuminate WHITE, and on some vehicles, when Smart Cruise Control (SCC)* is engaged. It will remain WHITE when the system does not detect the lane markers. When the system detects the lane markers and can assist the steering, the LFA icon will illuminate GREEN **B**.

LFA will operate only when these conditions are met:

- When the SCC is on and operating.
- LFA recognizes both sides of the lane markers the vehicle is traveling in.
- The vehicle is traveling slower than 95 mph.

Reminders:

If the ignition is cycled, LFA returns to its previous state, on or off, if activated in the User Settings menu and when combined with SCC. If using the steering wheel LFA button, then LFA defaults to off.

Smart Cruise Control (SCC) with Stop and Go System*12

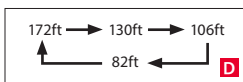
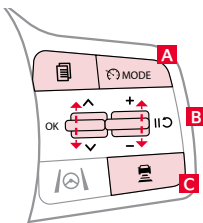

(Distances are approximate and vary depending on vehicle speed.)

SCC is designed to maintain a predetermined distance from vehicles detected ahead by automatically adjusting the driving speed as needed. With SCC on and activated, and the vehicle distance set, the system can slow or bring the vehicle to a complete stop when slowing or stopped traffic is detected ahead.

To set/adjust the SCC speed:

- Push the Driving Assist button **A** to turn the system ON. The CRUISE indicator will illuminate on the Instrument Cluster and speed will be set to the current vehicle speed.
- Press the RES+/SET- button **B** up/down to increase/decrease the set speed.
- The SET indicator light, set speed and vehicle-to-vehicle distance will illuminate on the Instrument Cluster's LCD screen.

To set the vehicle-to-vehicle distance: Press the Vehicle Distance button **C** on the steering wheel. The image on the LCD screen **D** will change when scrolling through the settings. Each time the button is pressed, the vehicle-to-vehicle distance will change.

To cancel SCC operation: Press the CANCEL button **B** or press the brake pedal.

To turn the SCC system OFF: Press the Driving Assist button **A**. The CRUISE indicator on the Instrument Cluster will turn OFF.

Smart Power Liftgate Operation*7

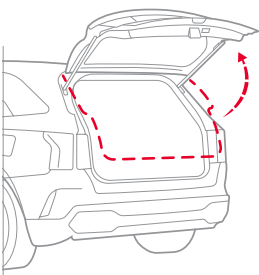

When the Smart Key is on your person and you are within close proximity to the back of the vehicle, the hazard lights will blink and a chime will sound for about 3 seconds as an alert that the Smart Power Liftgate is about to open. Then the alert system will blink and chime 2 additional times before opening the Smart Power Liftgate.

The Smart Power Liftgate feature is off by default. To enable the Smart Power Liftgate, go to User Settings in the LCD Instrument Cluster modes or the touch screen.¹

Quick Tips:

- During the Smart Power Liftgate alert, the Smart Power Liftgate can be deactivated with the Smart Key by pressing any button on the key fob or moving away from the detection area.

Forward Collision-Avoidance Assist-Pedestrian (FCA-Ped)¹²

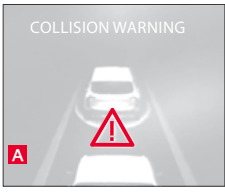

FCA is designed to detect and monitor a vehicle ahead or detect a pedestrian in the roadway through front view camera recognition and front radar signals to warn the driver that a collision is imminent, and if necessary, temporarily apply emergency braking. Initially, FCA provides Forward Collision Warning (FCW) when it detects a potential collision with a vehicle, pedestrian, or cyclist,¹ emitting an audible warning and visual alert on the Instrument Cluster **A**.

To adjust the FCA initial warning activation time, go to User Settings, Driver Assistance, Warning Timing, and then select Normal, Early, or Late.

If the system detects that the collision risk has increased, FCA automatically applies the brakes to reduce your speed, potentially helping to avoid or minimize the effects of a possible collision. FCA-Ped can be turned ON in the User Settings menu on the Instrument Cluster display or the touch screen.¹¹

FCA-Ped/FCW will become active when the:

- Engine Start/Stop button is ON.
- Vehicle is traveling faster than 5 mph.
- Electronic Stability Control (ESC) is ON.

Surround View Monitor (SVM)^{*1,12}

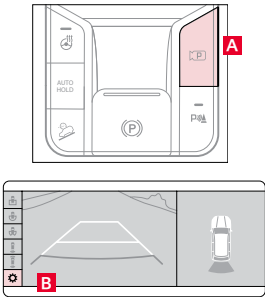

The SVM is a parking support system that shows the area around the front, rear, left, and right sides of the vehicle via four cameras displayed in the infotainment system display.

Press **A** to turn SVM ON/OFF.

- **When OFF:** The camera view will automatically display on the infotainment system screen when the vehicle is shifted into Reverse. The camera view will turn off when the vehicle is shifted out of Reverse.
- **When ON:** The camera view will display on the infotainment system screen in both Drive and Reverse. In Drive, the camera view will continue to display until the vehicle is traveling at speeds above approximately 9 mph. If you keep SVM ON, the camera view will reappear on the infotainment system display whenever the vehicle speed drops below approximately 9 mph.
- To change the SVM settings, press the onscreen settings icon **B** while the system is operating.

Highway Driving Assist (HDA)^{*13}

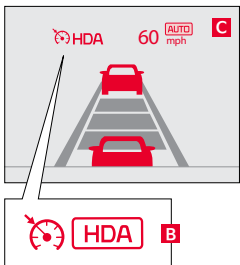
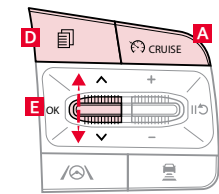

HDA is designed to adjust the speed of the vehicle when driving on limited/controlled access highways/freeways. The system can adjust the vehicle's speed based on available highway speed information. The automatic speed setting mode is designed to set the speed automatically by adjusting to the current speed limits of the highway the vehicle is traveling on.

To activate HDA, turn Smart Cruise Control (SCC)^{*} on by pressing the Driving Assist CRUISE / Driving Assist Mode **CRUISE** button^{*} **A** on the steering wheel. When HDA is activated and the conditions are met, the Instrument Cluster indicator **B** will illuminate GREEN. If the conditions are not met, HDA will be in standby mode and the indicator light **B** will illuminate WHITE. When in operation, and if both lanes are recognized, the Instrument Cluster will show the lanes illuminated WHITE and the HDA indicator illuminated GREEN **B**.

If HDA is activated, conditions are met and the SCC speed is set by the driver (at the posted highway speed limit or slower), HDA will enter the automatic speed setting mode. The set speed and AUTO will be displayed **C** in GREEN and an audible alert will sound.

HDA will operate only when these conditions are met:

- The vehicle is traveling slower than 110 mph or the highway speed limit.
- When driving on limited/controlled access highways/freeways.
- When the SCC is on and operating.
- When the SCC speed is set to current posted highway speed or slower.

HDA User Settings:

To enable HDA, press the Mode button **D** on the steering wheel and go to User Settings **D** in the Instrument Cluster. Press the Move (OK) button **E** up/down and press to Driver Assistance, then Driving Assist, Highway Driving Assist. Then press the OK button **E** to enable.

Some models access settings through the Vehicle Settings in the infotainment system. Press the Setup hard key on the infotainment system screen, then press **D** on the screen to enter Vehicle Settings.

#1 Brand Overall for Long-Term Dependability¹⁴



Movement that inspires

2023 Sorento X-Line SX Prestige shown on cover. Images or graphics for illustration only. ¹If equipped. ²Driving while distracted can result in a loss of vehicle control that may lead to an accident, severe personal injury, and death. The driver's primary responsibility is in the safe and legal operation of a vehicle, and use of any handheld devices, other equipment, or vehicle systems which take the driver's eyes, attention, and focus away from the safe operation of a vehicle or which are not permissible by law should never be used during operation of the vehicle. ³The Bluetooth® word mark and logos are registered trademarks owned by Bluetooth SIG, Inc. and any use of such marks by Kia is under license. A Bluetooth® enabled cell phone is required to use Bluetooth® Wireless Technology. ⁴Apple CarPlay, iPhone, and Siri are registered trademarks of Apple Inc., registered in the U.S. and other countries. CarPlay runs on your smartphone cellular data service. Normal data rates will apply. ⁵Android Auto vehicle user interface is a product of Google and its terms and privacy statements apply. Requires the Android Auto app on Google Play™ store and an Android compatible smartphone running Android 5.0 Lollipop or higher. Data plan rates apply. ⁶Android, Android Auto, and Google Play are trademarks of Google LLC or its affiliates. ⁷Purchase/lease of certain 2022 and newer Kia vehicles with Kia Connect (formerly UVO link) includes a complimentary 1-year subscription starting from new vehicle retail sale/lease date as recorded by the dealer. After your complimentary 1-year Kia Connect subscription expires, continued access to the full suite of Kia Connect services available on your Kia will require a paid subscription at the then current subscription rate or your use of certain Kia Connect features may immediately terminate. Use of Kia Connect is subject to agreement to the Kia Connect Privacy Policy (available at owners.kia.com/us/en/privacy-policy.html) and Terms of Service (available at owners.kia.com/us/en/terms-of-service.html). Kia Connect is transferable to subsequent owner during the original Kia Connect service term. Only use Kia Connect when safe to do so. Kia Access App is available from the Apple® App Store® or Google Play™ store. Kia America, Inc. reserves the right to change or discontinue Kia Connect at any time without prior notification or incurring any future obligation. Message and data rates may apply. Cellular and GPS coverage are required to use most features. Kia Connect features may vary by model, model year, and trim level. Features, specifications, and fees are subject to change. For more on details and limitations, visit www.kia.com or your authorized Kia dealer. Apple and App Store are registered trademarks of Apple Inc. Google and logos are trademarks of Google LLC. Kia Connect may currently be unavailable for Model Year 2022 and newer vehicles sold or purchased in Massachusetts; please see the Kia Owner's Portal for updates on availability. ⁸Do not use remote climate control or remote start if vehicle is in an enclosed area (e.g., closed garage) or a partially enclosed area without ventilation. Close all doors leading from adjacent living areas to the vehicle area before executing a remote climate control or remote start command. ⁹Driving with liftgate open may be unlawful and can draw dangerous exhaust fumes into vehicle; if you choose to do so, keep air vents and windows open for ventilation. ¹⁰When engaged, Driver Attention Warning is not a substitute for safe driving and may not detect all instances of inattentive driving practices. Failure to pay attention to travel conditions and vehicle operation could result in loss of vehicle control. Always drive safely and use caution. ¹¹Charging system only works with select devices. Refer to the vehicle's Owner's Manual for warnings and instructions. ¹²To avoid burn risk, use extreme caution when operating seat warmers. Refer to Owner's Manual for operating instructions and safety information. ¹³ISLA and MSLA are supplemental systems. The driver remains responsible for ensuring the safe and legal operation of the vehicle, including its speed. ¹⁴Driver-assist technologies are not substitutes for safe driving, and may not detect all objects surrounding vehicle. Always drive safely and use caution. ¹⁵Highway Driving Assist is not a substitute for safe driving, may not detect all objects surrounding the vehicle, and only functions on certain federal highways. Always drive safely and use caution. ¹⁶Kia received the fewest reported problems among mass market brands in the J.D. Power 2022 U.S. Vehicle Dependability Studies based on 2019 models. See jdpower.com/awards for 2022 details.